

RoHS

REV.	LOCAS.	DESCRIPTION	DRAW.	DATE.
01	NEW	INITIAL RELEASE.	Junly	2009.08.15
02	△2	ECN20120012	Junly	2012.03.15
03	△3	ECN20120018	Junly	2012.04.27

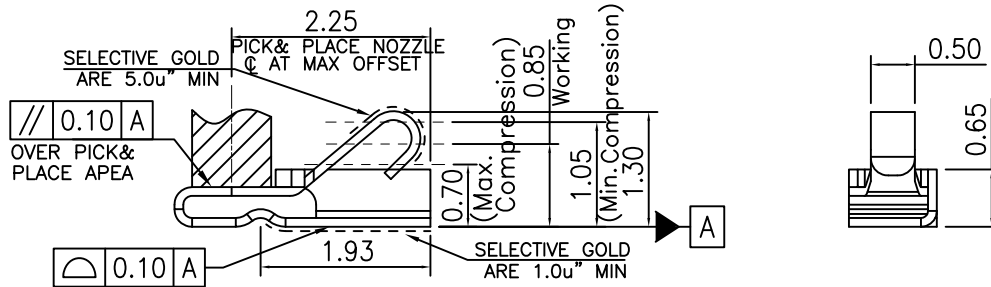
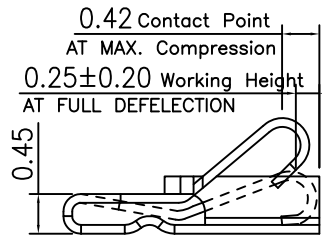
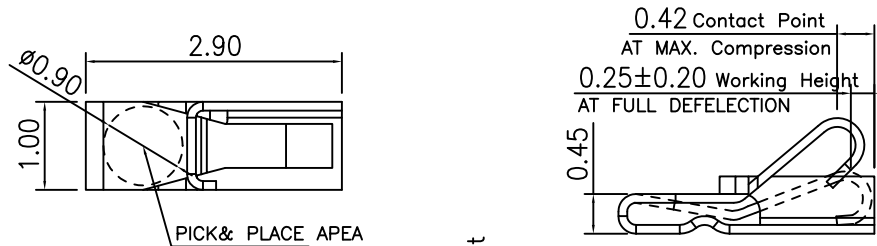

NOTES:

- 1.MATERIAL:
 - 1.1 Copper Alloy
- 2.SPECIALITY:
 - 2.1 Contact Resistance:30mΩ Max
 - 2.2 Operating Temperature:-20°C~+65°C
 - 2.3 Max. Beam Deflection:0.6mm.On Contact POINT
 - 2.4 Contact current rating:1.5A. min
- 3. RF PERFORMANCE:
 - 3.1 Impedance:50 ohm.
 - 3.2 Insertion Loss: 0.6dBMax.(DC~3GHz)
 - 3.3 VSWR: 1.5MAX.(DC~3GHz)

LOAD/DEFLECTION GRAPH
MINIMUM FORCE
TOLERANCE +0.25N / -0.0N

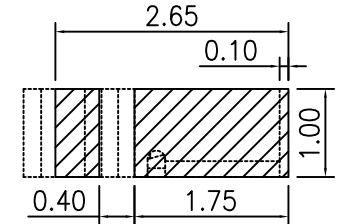
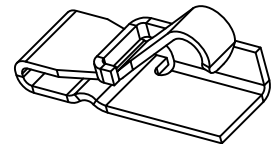
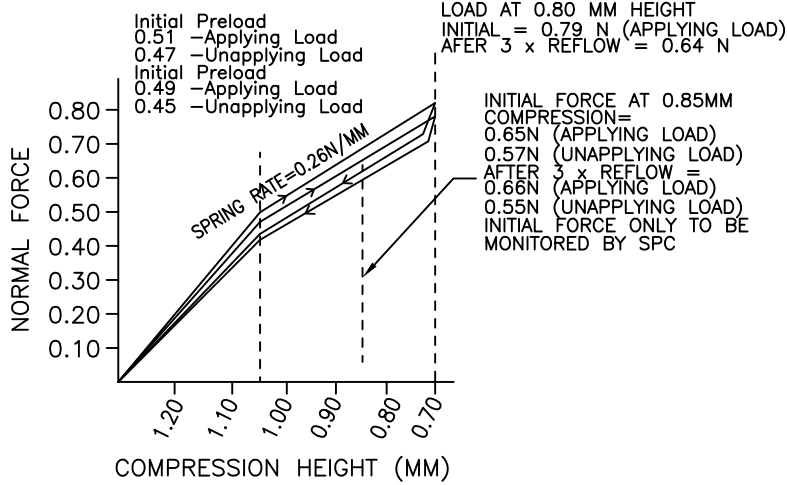

RECOMMENDED PCB LAYOUT
TOLERANCE:±0.05

MEASURE POINT:
QUADRANT POINT (QP)
TANGENCY POINT (TP)
INTERSECTION POINT (IP)



UNLESS OTHERWISE SPECIFIED, TOLERANCE:	DESING	Junly	DATE	2012.04.27	TITLE:	ANTENNA RF SPRING SMT TYPE H:1.30mm L:2.90*1.00*1.30mm							
X. ±0.25	CHECKED	Nick	DATE	2012.04.27	PART NO:	P-JS-29-13		REV:	03	SCALE:	12:1	UNIT:	mm
X.x ±0.20	APPROVED	Liufei	DATE	2012.04.27	DRAWING NO:	P-JS-29-13		SIZE:	A4	SHEET:	1/1		
X.xx ±0.15													
ANGULAR ±3°													